

INSULATING SAVES ENERGY

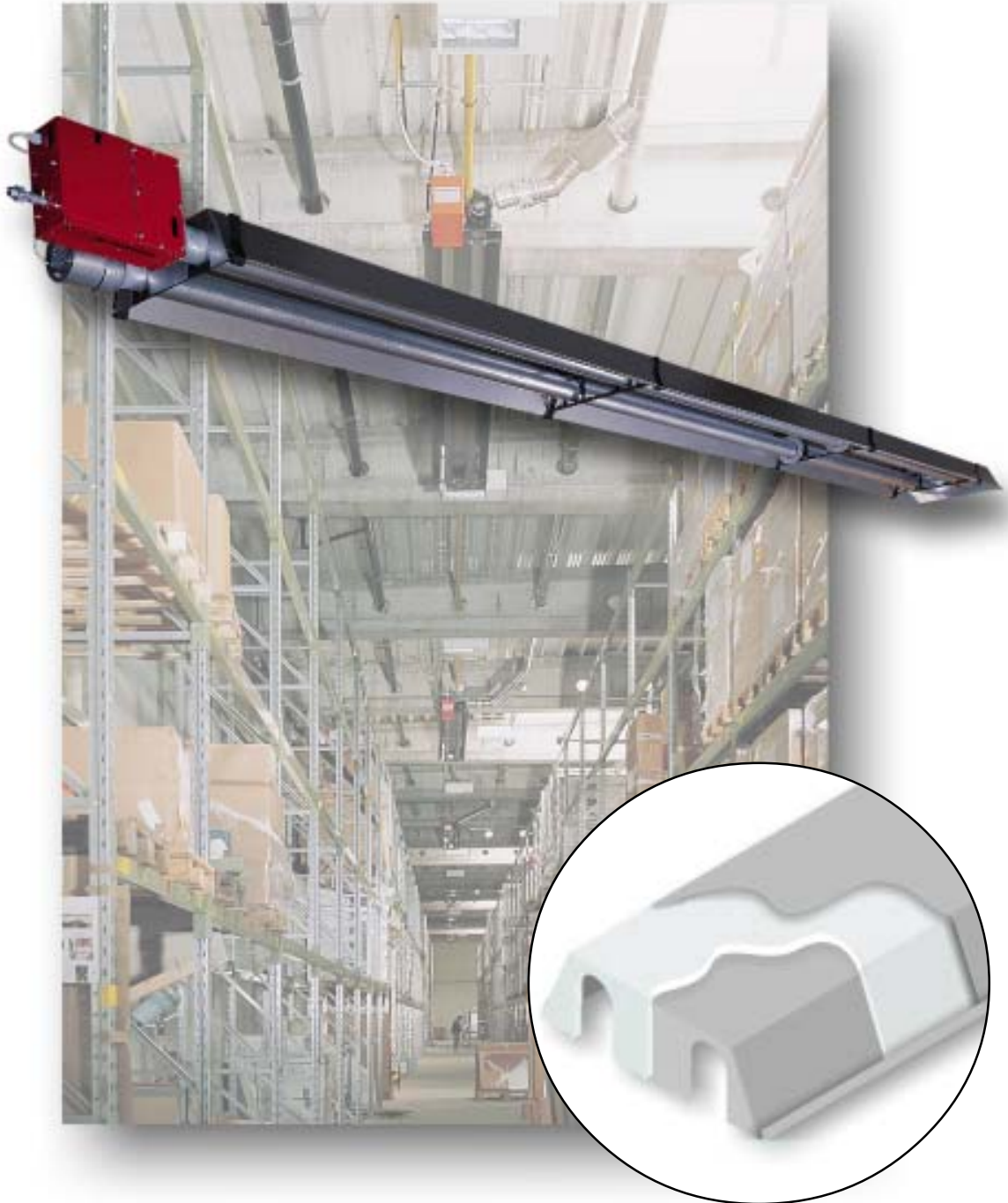

Schwank – Radiant Tube

calorSchwank 11 U

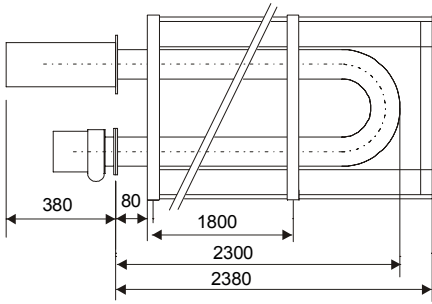

calorSchwank 20 U

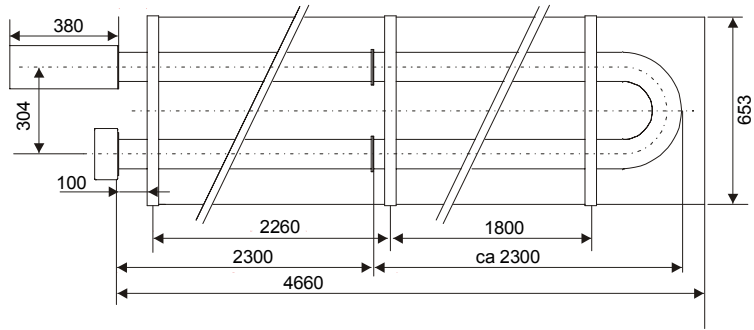

calorSchwank 33 U

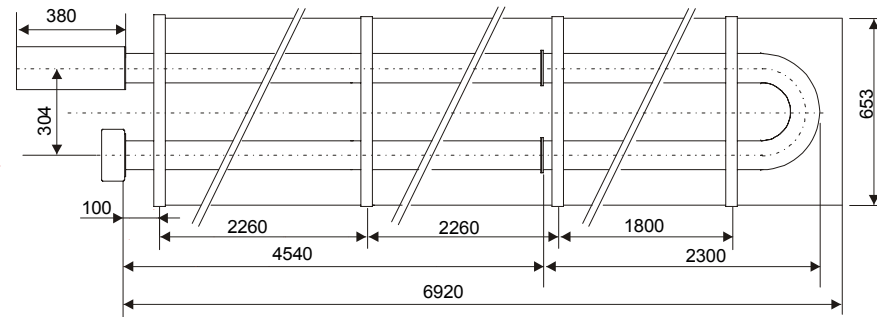

section calorSchwank 11U / 20U / 33U

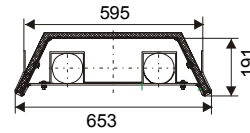

section calorSchwank 50U

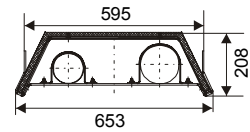

calorSchwank 50 U

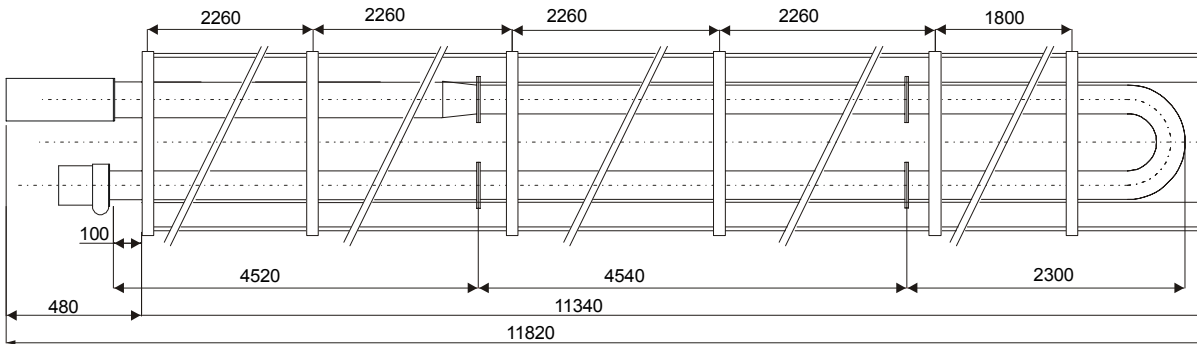

Gas	calorSchwank				
	11 U	20 U	33 U	50 U	
Nat. Gas H / G 20 (H _{s,n} = 11,07 kWh/m ³)	heat input (H _s , gross caloric value) kW	10,7	18,9	31,1	48,8
	combustion power (output) - kW	9,8	17,3	28,5	45,0
	gas consumption in m ³ /h	1,03	1,82	3,00	4,70
Propane / G 31 (H _{s,n} = 13,98 kWh/kg)	heat input (H _s , gross caloric value) kW	10,4	18,5	30,4	41,8
	combustion power (output) - kW	9,6	16,9	27,9	38,4
	gas consumption in kg/h	0,75	1,32	2,18	3,10
weight in kg	51	81	151	265	
air/exhaust connection in mm	Ø 80	Ø 80	Ø 100	Ø 100	
electrical consumption in W	80	80	80	70	
electrical protection	IP 20	IP 20	IP 20	IP 24	
gas connection (female)	R 1/2"	R 1/2"	R 1/2"	R 3/4"	
electrical supply in V	220-240 V/ 50 Hz ~				
ignition and control	spark ignition and ionisation electrode run by automatic controller				
CE-Identification	CE-0085AU0298				

Appliance

- as single heater with individual flue fan
- as System D, several heaters with central flue fan

Air/exhaust requirements

- for indoor dependent operation (Art. A and B)
- for indoor independent operation (Art. C)

min. connection pressure

Nat. gas H: 15 mbar
Propane: 40 mbar

max. connection pressure

Nat. gas and Propane: 60 mbar